

# SNACK COLLECTION

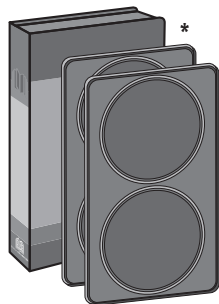

FR  
NL  
DE  
EN  
IT  
ES  
PT  
EL  
TR  
DA  
NO  
SV  
FI  
CS  
SK  
HU  
PL  
RU  
UK  
SL  
SR  
BS  
BG  
RO  
HR  
ET  
LT  
LV  
JA  
KO  
ZH  
MS  
TH  
AR  
FA

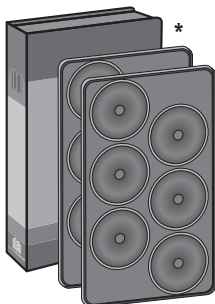

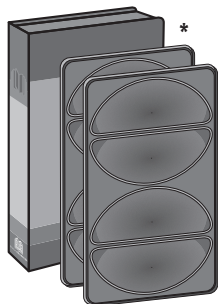
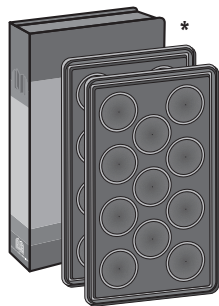
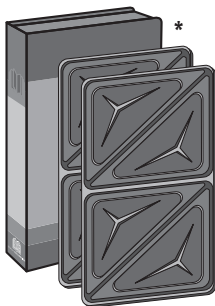
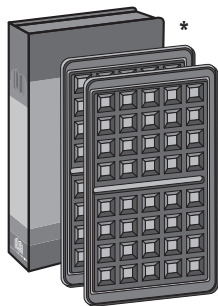
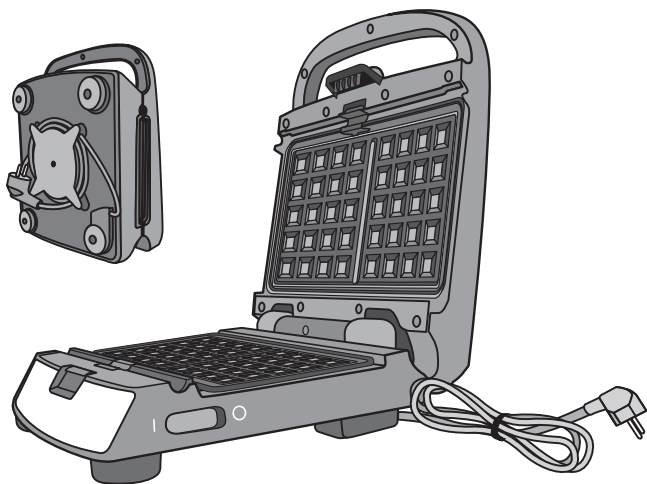
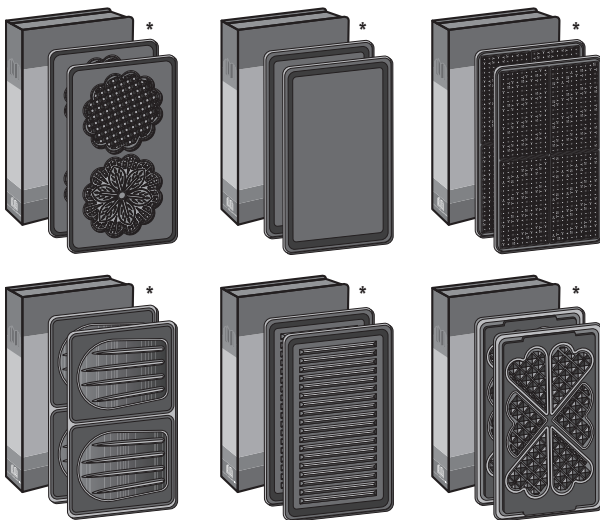

- \* FR : Selon modèles et/ou disponibles en magasin ou internet.  
 NL : Afhankelijk van het model en/of de beschikbaarheid in de winkel of online.  
 DE : Je nach Modell und / oder im Geschäft oder online erhältlich.  
 EN : Depending on the model and/or available in store or online.  
 IT : A seconda del modello e/o disponibile in negozio o online.  
 ES : Dependiendo del modelo y / o disponibles en la tienda o en línea.  
 PT : Dependendo do modelo e / ou disponível na loja ou online.  
 EL : Ανάλογα με το μοντέλο και/ή διατίθενται στα καταστήματα ή το Διαδίκτυο.  
 TR : Modele ve/veya mağazada ya da çevrimiçi olarak bulunabilirliğe bağlıdır.  
 DA : Afhængig af model og/eller rådighed i butikken eller online.  
 NO : Avhengig av modell og / eller tilgjengelig i butikken eller på nettet.  
 SV : Beroende på modell och/eller tillgänglighet i butik eller online.  
 FI : Riippuen mallista ja/tai saatavilla liikkeessä tai verkossa.  
 CS : Dostupnost v obchodě nebo online v závislosti na modelu a/nebo s předmětu.  
 SK : Dostupnosť v obchode alebo on-line v závislosti na modeli a/alebo s predmetom.  
 HU : Tiputól függően és/vagy az üzlet vagy az online bolt raktárkészletének függvényében.  
 PL : W zależności od modelu i/lub pod warunkiem dostępności w sklepie lub w Internecie.  
 RU : Зависит от модели и/или от наличия в продаже.  
 UK : Залежно від моделі та/або наявності в магазинах чи інтернет-магазинах.  
 SL : Odvisno od modela in razpoložljivosti izdelka v trgovini in/ali na spletu.  
 SR : Zavisno od modela i/ili zalih ili onlajn dostupnosti.  
 BS : Zavisno od modela i/ili zalih ili dostupnosti na mreži.  
 BG : В зависимост от модела и/или предмета на складова или онлайн наличност.  
 RO : În funcție de model și/sau de disponibilitățile din magazin sau online.  
 HR : Ovisno o modelu i/ili zalihama ili dostupnosti na mreži.  
 ET : Olenevalt mudelist ja/või kättesaadavusest laos või internetis.  
 LT : Priklausomai nuo modelio ir (ar) yra parduotuvėje ar interneto parduotuvėje.  
 LV : Atkarībā no modeļa un/vai pieejamības noliktavā vai tiešsaistes veikalā.  
 JA : モデルおよび/もしくはは店やオンラインで利用可能なものに依りて  
 KO : 모델에 따라 다름, 매장 또는 온라인에서 구입 가능.  
 ZH : 視乎型號以及/或門店或網上商店之供應情況而定  
 MS : Bergantung kepada model dan/atau boleh didapati di kedai atau dalam talian  
 TH : ขึ้นอยู่กับรุ่น และ/หรือ สินค้าที่มีจำหน่ายในร้านค้าหรือทางออนไลน์  
 AR : حسب الطراز و/أو التوفر في المتجر أو عبر الإنترنت.  
 FA : بسته به مدل و یا موجودی در فروشگاه یا به صورت آنلاین.

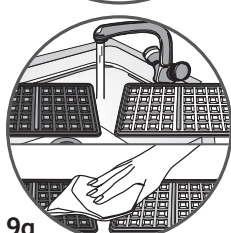
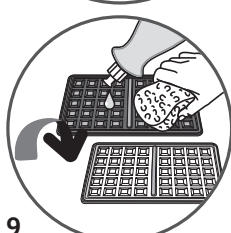
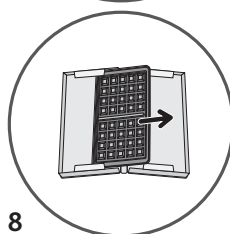
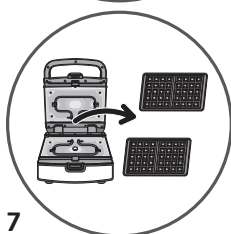
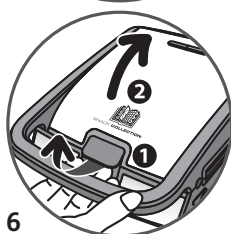
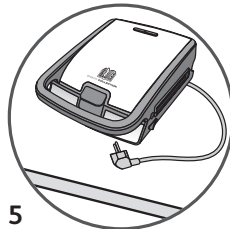
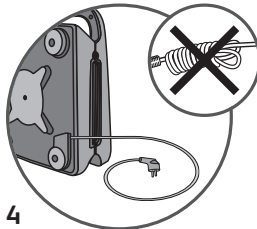
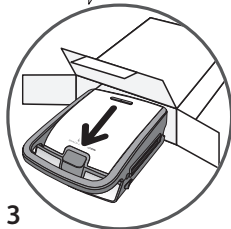
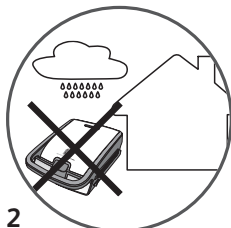



C

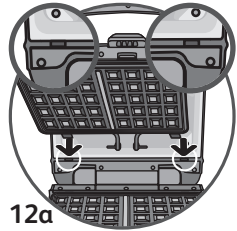
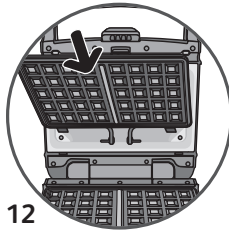
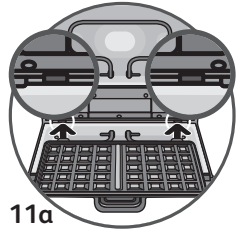
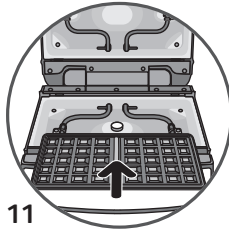
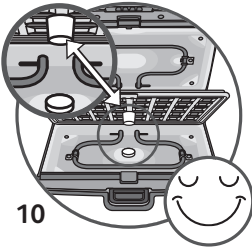

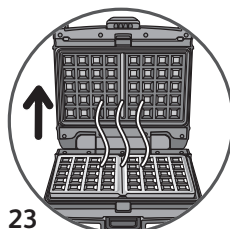
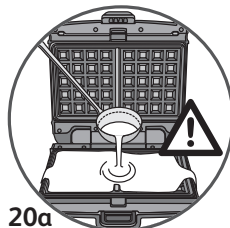
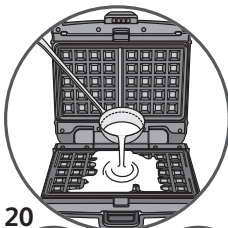
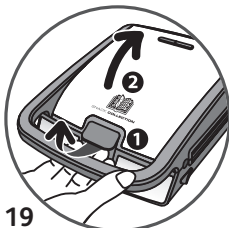
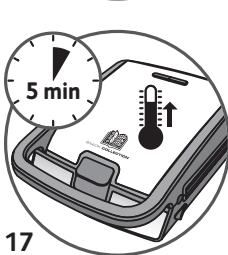
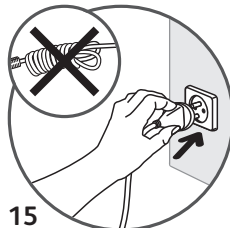
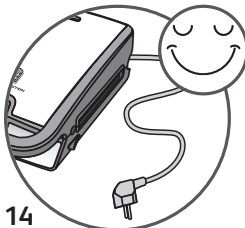

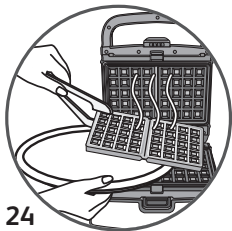

24

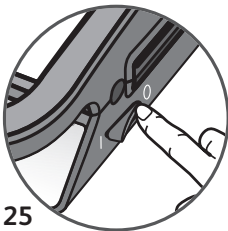

25

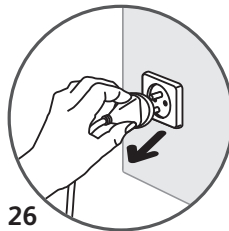

26

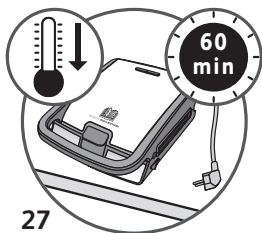

27

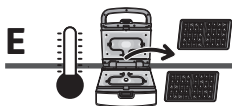

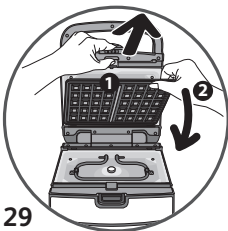

28



29

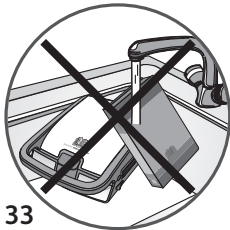
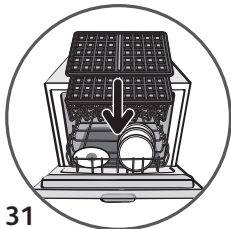
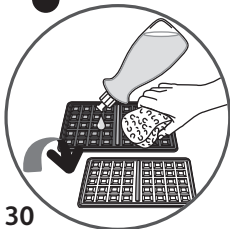



**F**  

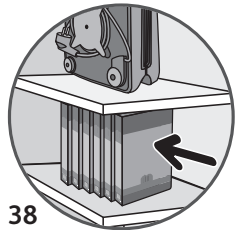
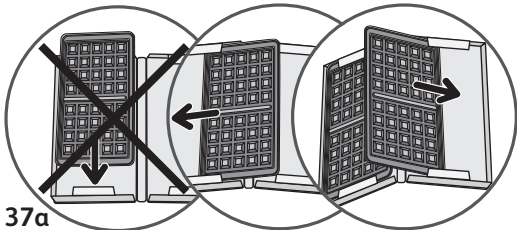
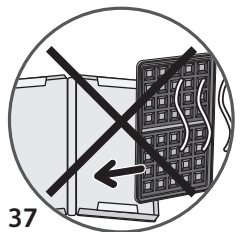
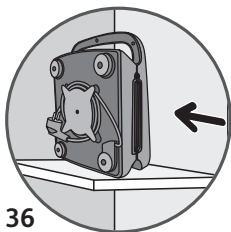

**G** 



## INTERNATIONAL GUARANTEE : COUNTRY LIST

|              |   |  |  |
|---|--|---|---|
| الجزائر<br><b>ALGERIA</b>   | CIJA<br>9 rue Puvis de Chavannes - Saint Euquene - Oran  | (0)41 28 18 53  | 1 an<br>1 year  |
| <b>ARGENTINA</b>  | GRUPE SEB ARGENTINA S.A<br>Billinghurst 1833 3° - C1425DTK - Capital Federal - Buenos Aires  | 0800-122-2732   | 2 años<br>2 years   |
| ՀԱՅԱՍՏԱՆ<br><b>ARMENIA</b>  | ՓԲԸ Գրուպու ՍԵԲ-Վ,<br>125171 Մոսկվա, Լենինգրադյան - խեմուրի, 16A, բին.3  | (010) 55-76-07  | 2 տարի/<br>2 years  |
| <b>AUSTRALIA</b>  | GRUPE SEB AUSTRALIA<br>PO Box 7535, - Silverwater NSW 2128   | 02 97487944   | 1 year  |
| <b>ÖSTERREICH<br/>AUSTRIA</b>   | SEB ÖSTERREICH GmbH<br>Campus 21 - Businesspark Wien Süd - Liebermannstr. A02 702 - 2345 Brunn am Gebirge  | 01 8903476  | 2 Jahre<br>2 years  |
| <b>BELGIQUE / BELGIE<br/>BELGIUM</b>  | GRUPE SEB BELGIUM SA NV<br>25 avenue de l'Espérance - ZI - 6220 Fleurus  | 070 23 31 59  | 2 ans<br>2 years  |
| <b>БЕЛАРУСЬ / BELARUS</b>   | ЗАО «Група СЕБ-Восток»,<br>Ленинградское - шоссе, д. 16А, стр. 3   | 017 2239290   | 2 года<br>2 years   |
| <b>BOSNA I<br/>HERCEGOVINA</b>  | SEB Développement<br>Predstavnništvo u BiH - Vrazova 8/II - 71000 Sarajevo   | Info-linija za potrošače<br>033 551 220   | 2 godine<br>2 years   |
| <b>BRASIL<br/>BRAZIL</b>  | SEB COMERCIAL DE PRODUTOS DOMESTICOS LTDA<br>Rua Venâncio Aires, 433/437/447, Pompéia, São Paulo/SP  | 0800-119933   | 1 ano<br>1 year   |
| <b>БЪЛГАРИЯ /<br/>BULGARIA</b>  | ГРУП СЕБ БЪЛГАРИЯ ЕООД<br>Ул. Борова 52 Г, ет. 1, офис 1. - 1680 София   | 0700 10 330   | 2 години<br>2 years   |
| <b>CANADA</b>   | GRUPE SEB CANADA<br>345 Passmore Avenue - Toronto, ON M1V 3N8  | 800-418-3325  | 1 an<br>1 year  |
| <b>CHILE</b>  | GRUPE SEB CHILE Comercial Ltda - Av. Providencia, 2331, piso 5,<br>oficina 501 Santiago  | 12300 209207  | 2 años<br>2 years   |
| <b>COLOMBIA</b>   | GRUPE SEB COLOMBIA<br>Apartado Aereo 172, Kilometro 1 - Via Zipaquirá - Cajica Cundinamarca  | 18000919288   | 2 años<br>2 years   |
| <b>HRVATSKA<br/>CROATIA</b>   | SEB Développement S.A.S.<br>Vodnjanska 26 - 10000 Zagreb   | 01 30 15 294  | 2 godine<br>2 years   |
| <b>ČESKÁ REPUBLIK /<br/>CZECH REPUBLIC</b>  | GRUPE SEB ČR spol. s r. o.<br>Jankovcova 1569/2c - 170 00 Praha 7  | 731 010 111   | 2 roky<br>2 years   |
| <b>DANMARK</b>  | GRUPE SEB NORDIC AS<br>Tempovej 27 - 2750 Ballerup   | 44 663 155  | 2 år<br>2 years   |
| <b>DEUTSCHLAND<br/>GERMANY</b>  | GRUPE SEB DEUTSCHLAND GmbH / KRUPS GmbH<br>Herrnrainweg 5 - 63067 Offenbach  | 0212 387 400  | 2 Jahre<br>2 years  |
| <b>EESTI / ESTONIA</b>  | GRUPE SEB POLSKA SP Z O.O.<br>ul. Bukowińska 22b 02-703 Warszawa   | 5 800 3777  | 2 aastat<br>2 years   |
| <b>SUOMI / FINLAND</b>  | Grupa SEB Finland<br>Kutojantie 7 - 02630 Espoo  | 09 622 94 20  | 2 Vuotta<br>2 years   |
| <b>FRANCE - Includant uniquement<br/>Martinique, Guadeloupe,<br/>Réunion &amp; St. Martin</b> | GRUPE SEB FRANCE<br>Service Consommateur Tefal BP 15 - 69131 ECULLY CEDEX  | 09 74 50 47 74  | 1 an<br>1 year  |
| <b>ΕΛΛΑΔΑ / GREECE</b>  | SEB GROUPE ΕΛΛΑΔΟΣ Α.Ε.<br>Οδός Καβαλιέρητου 7 Τ.Κ. 145 64 Ν. Κηφισιά  | 2106371251  | 2 χρόνια<br>2 years   |
| <b>香港 / HONG KONG</b>   | SEB ASIA Ltd. Room 903, 9/F, North Block, Skyway House -<br>3 Sham Mong Road, Tai Kok Tsui, Kowloon - Hong-Kong                                  | 852 8130 8998   | 1 year  |
| <b>MAGYARORSZÁG /<br/>HUNGARY</b>   | GRUPE SEB CENTRAL-EUROPE Kft.<br>Táviró köz 4 2040 Budaörs   | 06 1 801 8434   | 2 év<br>2 years   |
| <b>INDONESIA</b>  | Grupa SEB Indonesia (Representative office)<br>Sudirman Plaza, Plaza Marein 8th Floor<br>JL Jendral Sudirman Kav 76-78, Jakarta 12910, Indonesia | +62 21 5793 6881  | 1 year  |
| <b>ITALIA<br/>ITALY</b>   | GRUPE SEB ITALIA S.p.A.<br>Via Montefeltro, 4 - 20156 Milano   | 199207354   | 2 anni<br>2 years   |
| <b>JAPAN</b>  | GRUPE SEB JAPAN Co. Ltd.<br>1F Tanakawa Muse Building, 3-14-13, Higashi Gotanda, - Shinagawa-Ku, Tokyo 141-0022                                  | 0570-077772   | 1 year  |
| <b>ҚАЗАҚСТАН<br/>KAZAKHSTAN</b>   | ЖАҚ «Група СЕБ-Восток» 115171 Мәскеу,<br>Ленинградское шоссе, 16А, 3 үйі   | 727 378 39 39   | 2 жыл<br>2 years  |
| <b>KOREA</b>  | (유)그룹 세브 코리아<br>서울시 종로구 서린동 88 서린빌딩 3층 - 110-790   | 1588-1588   | 1 year  |
| <b>LATVJA / LATVIA</b>  | GRUPE SEB POLSKA SP Z O.O.<br>ul. Bukowińska 22b 02-703 Warszawa   | 6 716 2007  | 2 gadi<br>2 years   |

# INTERNATIONAL GUARANTEE : COUNTRY LIST

|  |    |  |  |
|---|---|---|---|
| LIETUVA / LITHUANIA   | GRUPE SEB POLSKA SP Z O.O.<br>ul. Bukowińska 22b 02-703 Warszawa  | 6 470 8888  | 2 metai<br>2 years  |
| LUXEMBOURG  | GRUPE SEB BELGIUM SA NV<br>25 avenue de l'Espérance - ZI - 6220 Fleurus   | 0032 70 23 31 59  | 2 ans<br>2 years  |
| MACEDONIA   | Grupe SEB Bulgaria EOOD - Office 1, floor 1, 52G Borovo St., 1680 Sofia - Bulgaria<br>ГРУП СЕБ БЪЛГАРИЯ ДООЕЛ - Ул. Борово 52 Г, сн. 1, офис 1, 1680 София - България | (0)2 20 50 022  | 2 години<br>2 years   |
| MALAYSIA  | GRUPE SEB MALAYSIA SDN. BHD<br>Unit No. 402-403, Level 4, Uptown 2, No. 2, Jalan SS21/37,<br>Damansara Uptown, 47400, Petaling Jaya, Selangor D.E. Malaysia           | 65 6550 8900  | 1 year  |
| MEXICO  | G.S.E.B. MEXICANA, S.A. de C.V. Goldsmith 38 Desp. 401, Col. Polanco -<br>Delegacion Miguel Hidalgo - 11 560 Mexico D.F.  | (01800) 112 8325  | 1 años<br>1 year  |
| MOLDOVA   | ТОВ «Грун СЕБ Україна»<br>02121, Харківське шосе, 201-203, 3 поверх, Київ, Україна  | (22) 929249   | 2 ani<br>2 years  |
| NETHERLAND<br>The Netherlands   | GRUPE SEB NEDERLAND BV<br>Generatorsstraat 6 - 3903 LJ Veenendaal   | 0318 58 24 24   | 2 jaar<br>2 years   |
| NEW ZEALAND   | GRUPE SEB NEW ZEALAND<br>Unit E, Building 3, 195 Main Highway, Ellerslie, - Auckland  | 0800 700 711  | 1 year  |
| NORGE<br>NORWAY   | GRUPE SEB NORDIC AS<br>Tempovej 27 - 2750 Ballerup DANMARK  | 815 09 567  | 2 år<br>2 years   |
| PERU  | GRUPE SEB Perú<br>Av. Camino Real N° 111 of. 805 B - San Isidro - Lima - Perú   | 441 4455  | 1 años<br>1 year  |
| POLSKA / POLAND   | GRUPE SEB POLSKA SP Z O.O.<br>ul. Bukowińska 22b 02-703 Warszawa  | 0801 300 421 koszt jak<br>za połączenie lokalne                                   | 2 lata<br>2 years   |
| PORTUGAL  | GRUPE SEB IBÉRICA SA<br>Urb. da Matinha - Rua Projectada à Rua 3 - Bloco1 - 3° B/D 1950 - 327 Lisboa  | 808 284 735   | 2 anos<br>2 years   |
| REPUBLIC OF IRELAND   | GRUPE SEB IRELAND<br>Unit B3 Aerodrome Business Park, College Road, Rathcoole, Co. Dublin   | 01 677 4003   | 1 year  |
| ROMÂNIA / ROMANIA   | GRUPE SEB ROMÂNIA<br>Str. Daniel Constantin nr. 8 - 010632 București  | 0 21 316 87 84  | 2 ani<br>2 years  |
| РОССИЯ / RUSSIA   | ЗАО «Группа СЕБ-Восток», 119180 Москва,<br>125171, Москва, Ленинградское шоссе, д. 16А, стр. 3  | 495 213 32 30   | 2 года<br>2 years   |
| SRBIJA / SERBIA   | SEB Developpement<br>Đorđa Stanojevića 11b 11070 Novi Beograd   | 060 0 732 000   | 2 godine<br>2 years   |
| SINGAPORE   | GRUPE SEB SINGAPORE PLY LTD.<br>59 Jalan Pemimpin, #04-01/02 L&Y Building - Singapore 577218  | 65 6550 8900  | 1 year  |
| SLOVENSKO /<br>SLOVAKIA   | GRUPE SEB SLOVENSKO s.r.o.<br>Rybničná 40 - 831 07 Bratislava   | 233 595 224   | 2 roky<br>2 years   |
| SLOVENIJA<br>SLOVENIA   | SEB d.o.o<br>Gregorčičeva ulica 6 - 2000 MARIBOR  | 02 234 94 90  | 2 leti<br>2 years   |
| ESPAÑA<br>SPAIN   | GRUPE SEB IBÉRICA S.A.<br>Almogüvers, 119-123, Complejo Ecourban - 08018 Barcelona  | 902 31 24 00  | 2 años<br>2 years   |
| SVERIGE<br>SWEDEN   | TEFAL SVERIGE SUBSIDIARY OF GROUP SEB NORDIC<br>Truckvägen 14 A, 194 52 Upplands Väsby  | 08 594 213 30   | 2 ans /<br>Järrhre  |
| TAIWAN  | SEB ASIA Ltd. Taiwan Branch<br>4F., No. 37 Dexing W. Rd., Shilin Dist., Taipei City 11158, Taiwan (R.O.C.)  | 886-2-2833 3716   | 1 year  |
| THAILAND  | GRUPE SEB THAILAND<br>2034/66 Italthai Tower, 14th Floor, n° 14-02, - New Petchburi Road,<br>Bangkapi, Huaykwang, Bangkok, 10320                                      | 662 351 8911  | 2 years   |
| TÜRKIYE<br>TURKEY   | GRUPE SEB ISTANBULAS<br>Beybi Giz Plaza Dereboyu Cad. - Meydan Sok. - No: 28 K.12 Maslak  | 216 444 40 50   | 2 YIL<br>2 years  |
| U.S.A.  | GRUPE SEB USA<br>2121 Eden Road - Millville, NJ 08332   | 800-395-8325  | 1 year  |
| УКРАЇНА /<br>UKRAINE  | ТОВ «Грун СЕБ Україна»<br>02121, Харківське шосе, 201-203, 3 поверх, Київ, Україна  | 044 492 06 59   | 2 роки<br>2 years   |
| UNITED KINGDOM  | GRUPE SEB UK Ltd.<br>Riverside House, Riverside Walk Windsor, Berkshire, SL4 1NA  | 0845 602 1454   | 1 year  |
| VENEZUELA   | GRUPE SEB VENEZUELA<br>Av Eugenio Mendoza, Centro Lebronia, Torre - ING Bank, Piso 15, Ofc 155<br>Urb. La Castellana, Caracas   | 0800-7268724  | 2 años  |
| VIETNAM   | Vietnam Fan Joint Stock Company<br>25 Nguyen Thi Nhu Str, Ward 9, Tan Binh Dist, HCM city   | +84-8 38644037<br>+84-8 38645830  | 1 year  |

# INTERNATIONAL GUARANTEE

**Date of purchase:** ..... / Date d'achat / Fecha de compra /  
Data da compra / Data d'acquisto / Kaufdatum / Aankoopdatum / Købsdato / Inköpsdatum /  
Kjøpsdato / Ostopäivä / Data zakupu / Data vânzării / Įsigijimo data/ Ostukuupäev / Datum  
nakupa / Sorozatszám / Dátum nákupu / Pirkuma datums / Datum Kupovine / Datum kupnje /  
Data cumpărării / Datum nákupu / Tarikh pembelian / Tanggal pembelian / Ngày mua hàng/  
Satin alma tarihi / Дата прџдажи / Дата прџдажу / Дата на закупуване / Датум на купување /  
Сатылган мерзими / Ημερομηνία αγοράς/ Ὤμερομηνία ἀγορᾶς / วันที่ซื้อ / 購買日期 / 購入日 / 구입일자 /  
خريد تاريخ / تاريخ الشراء

**Product reference:** ..... / Référence du produit / Referencia del  
producto / Referência do produto / tipo de prodotto / Typnummer des Gerätes / Artikelnummer  
van het apparaat / Referencenummer / Produktreferens / Artikkelnnummer / Tuotenumero /  
referenca produktu / Model / Gaminio numeris / Toote viitenumber / Tip aparata / Vásárlás  
kelte / Typ výrobu / Produkta atsaucens numurs / Model proizvoda / Oznaka proizvoda / Cod  
produs / Produkt rujuklan / Referensi produk / Mã sản phẩm/ Ürün kodu / Мпдель / Мпдель /  
Мпдел на уреда / Мпдели / Κωδικός προϊόντος / Πηλη / รุ่นผลิตภัณฑ์ / 產品模型 / 製品レファレ  
ンス番 / 제품명 / مرجع كامل محصول / مرجع المنتج الكامل

**Retailer name & address:** ..... /  
Nom et adresse du vendeur / Nombre y dirección del minorista / Nome e endereço do revendedor /  
Nome e indirizzo delnegozio / Name und Anschrift des Händlers / Naam en adres van de dealer /  
Forhandler navn & adresse / Återförsäljarens namn och adress / Forhandler navn og adresse /  
Jälleenmyyjän nimi ja osoite / Nazwa i adres sprzedawcy / Numele și adresa vânzătorului /  
Parduoctuvés pavadinimas ir adresas / Müüja kauplus ja address / Naziv in naslov trgovine /  
Tipuszmám / Názov a adresa predajcu / Veikala nosaukums un adrese / Naziv i adresa malprodaje /  
Naziv i adresa prodavca / Naziv i adresa prodajnog mjesta / Nume și adresă vânzător / Název a  
adresa prodejece / Nama dan alamat peruncit / Nama Toko Penjual dan alamat / Tên và địa chỉ  
cửa hàng bán/ Satici firmanin adi ve adresi / Название и адрес прџдавца / Назва i adresa  
прџдавця / Търговки пбект / Назив и адреса на прџдавницата / Сатушының аты және  
мекен-жайы / Επωνυμία και διεύθυνση καραζήμαρος / Ὤμερομηνία ἀγορᾶς / ห้าง  
ซื้อและที่อยู่ของห้าง/วันที่ซื้อ / 零售商的店名和地址/販売店の名前、住所/소매점 이름과 주소/  
نام و آدرس خرده فروش / اسم وعنوان بائع التجزئة

**Distributor stamp** ..... Cachet distributeur /Sello del distribuidor /  
Carimbo do revendedor / Timbro del negozio / Händlerstempel / Stempel van de dealer /  
Forhandler stempel / Återförsäljarens stämpel / Forhandler stempel / Jälleenmyyjän leima /  
pieczęć sprzedawcy / Ștampila vânzătorului / Antspaudas / Tempel / Žig trgovine / Eladó neve,  
címe/ Razítko predajcu / Zimogs / Pečat malprodaje/ Pečat prodavca / Pečat prodajnog  
mjesta / Ștampila vânzătorului/ Razítko prodejece/ Cap peruncit / Cap dari Toko Penjual / Cửa  
hàng bán đồng dấu/ Satici Firmanin Kaşesi / Печать прџдавца / Печатка прџдавця / Печат на  
търговския пбект / Печат на прџдавницата / Сатушының мөрі / Σφραγίδα καραζήμαρος /  
Ὤμερομηνία ἀγορᾶς / 零售商的蓋印 / 販売店印 / 소매점 직인 /  
فروش مهر خرده / ختم بائع التجزئة

Ref. NC00128415